

# **xLath™ Heat Exchange Module HXM1624G30 specification**

**xLath™** illustration:

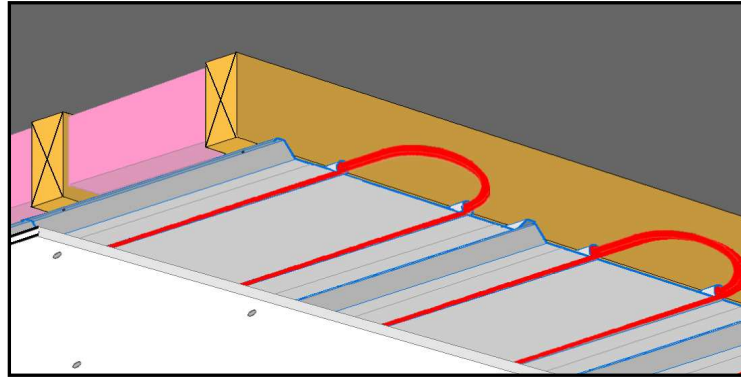

Nominal Size: 16" x 24"  
Module Size: 16 13/16" x 23 7/8"  
Module Height: 3/4"  
Module Material: 30 gauge G30 galvanized steel  
Alternative coatings available  
Also available in aluminum  
Tube Groove: 5/8" for 1/2" PEX

Heat exchange capacity:

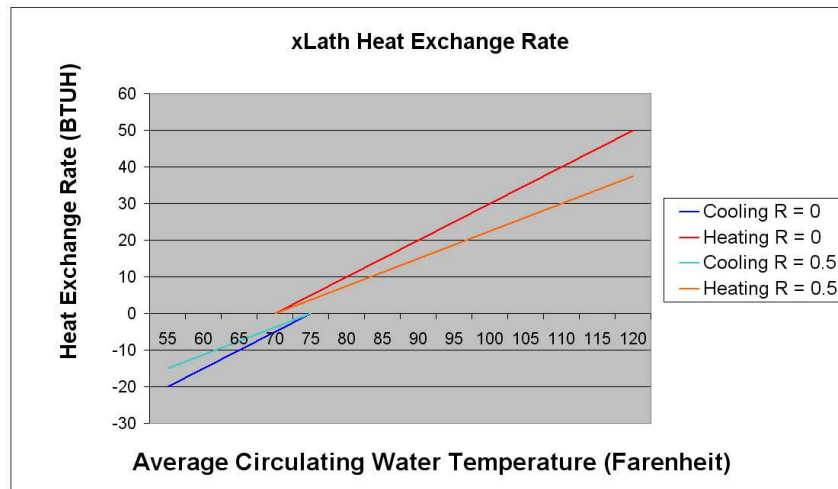

Module Profile:



CSI Masterformat:

Section 13080 Sound, Vibration and Seismic Control  
Section 15760 Terminal Heating and Cooling Unit, Finned – Tube Radiation

Protection:

Patent and Trademark Pending

Contact:

Dean T. Newberry  
Talbot Solar & Radiant Homes Inc.  
430 D St., Davis, CA 95616  
Tel: (530) 753-1900  
Fax: (530) 758-2050

Web:

[xLath.com™](http://xLath.com™)